

PHILIPS  
hue

**Warnings**  
Always make sure the luminaire is detached from the mains socket  
Always make sure the DC cable is detached from the power supply  
Staring at the operating light source may cause eye injury

#	Disassemble/dismantle steps	Tools needed
a	Remove the glass (1) from the base (10) by turning counter clockwise	-
b	Remove cover 1 (2)	FLATHEAD SCREWDRIVER
c	Remove cover 2 (3) by unclicking	-
d	Remove terminal block (4) by unclicking	-
e	Remove screws (5) from the LIGHT SOURCE - HUE CONNECT (6)	TORXHEAD SCREW DRIVER T10
f	Remove screws (7) from the CONTROL GEAR - PSU (8)	TORXHEAD SCREW DRIVER T10
g	Remove low voltage wires of the cable of LIGHT SOURCE - HUE CONNECT (6)	FLATHEAD SCREWDRIVER OR WAGO TOOL #2065
h	Remove low voltage wires of the LIGHT SOURCE - LED STRIP (9)	-
i	Remove LIGHT SOURCE-LIGHT STRIP (9)	See document: 200604 - Instruction LED Strip Removal Procedure

- A specific Wago tool #2065 can be ordered separately for wire insertion and release tool:



#	COMPONENT	QTY
1	GLASS	1
2	COVER 1	1
3	COVER 2	1
4	TERMINAL BLOCK	1
5	SCREW	2
6	LIGHT SOURCE - HUE CONNECT	1
7	SCREW	2
8	CONTROL GEAR - PSU	1
9	LIGHT SOURCE - LED STRIP	1
10	BASE	1

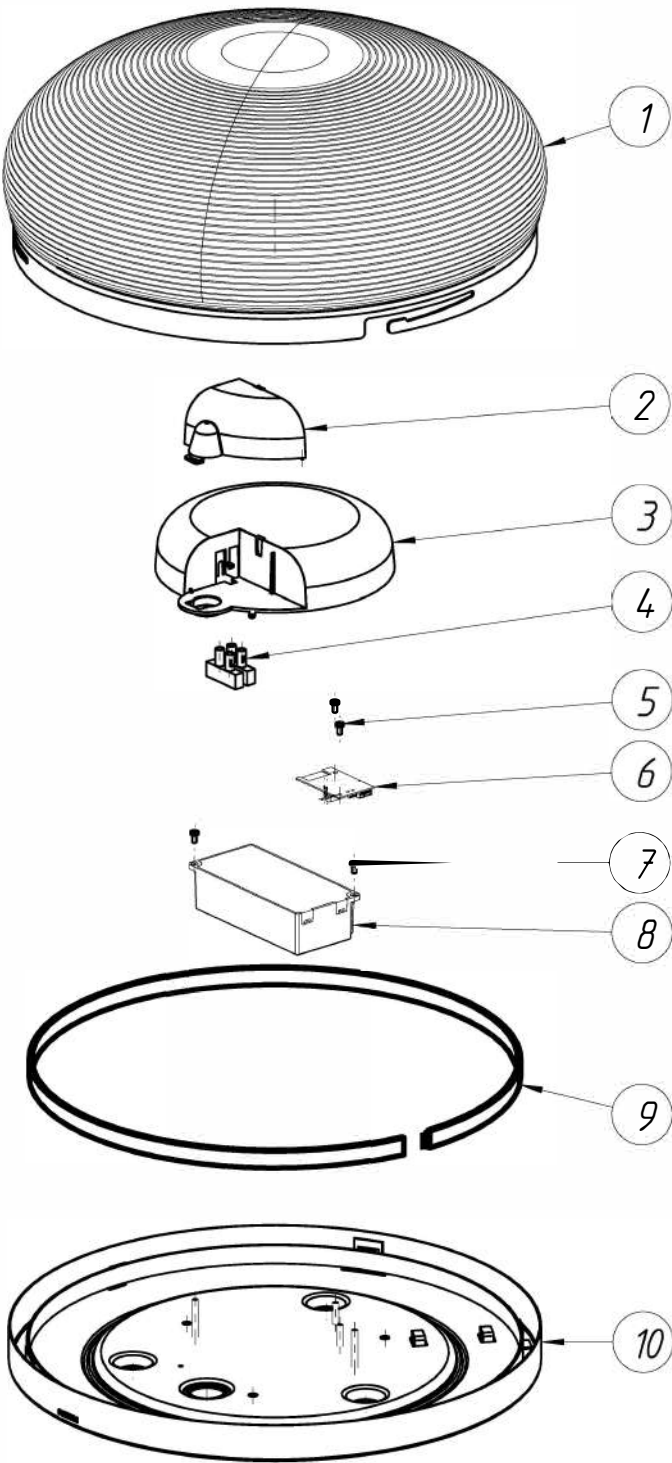

SKU	Color	Country
929003053501	White	EU/UK

STATUS		DESIGN ID	
FLOURISH Hue ceiling 32W 24V Disassembly instruction		01 2021-07-09	
NAME		LOCAL PART ID	
He Go		SH. 2	
CHECKED		DATE	
		2021-07-09	
		A3-L	

